

# FIELDS AT GULFSTREAM POLO PUD - PLAT EIGHT

A PLANNED UNIT DEVELOPMENT  
 BEING A REPLAT OF A PORTION OF PARCEL A, FIELDS AT GULFSTREAM POLO PUD - PLAT ONE, AS RECORDED IN PLAT BOOK 123, PAGES 80  
 THROUGH 95 OF THE PUBLIC RECORDS OF PALM BEACH COUNTY, FLORIDA,  
 LYING IN SECTION 29, TOWNSHIP 44 SOUTH, RANGE 42 EAST, PALM BEACH COUNTY, FLORIDA

THIS INSTRUMENT PREPARED BY  
 DAVID P. LINDLEY  
 OF  
**CAULFIELD and WHEELER, INC.**  
 SURVEYORS - ENGINEERS - PLANNERS  
 7900 GLADES ROAD, SUITE 100  
 BOCA RATON, FLORIDA 33434 - (561)392-1991  
 CERTIFICATE OF AUTHORIZATION NO. LB3591

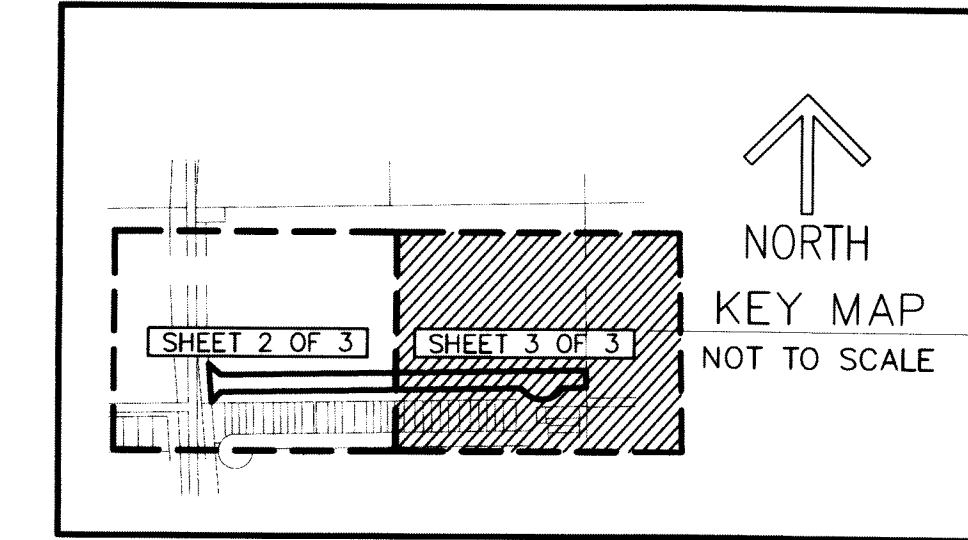

118  
**SHEET 3 OF 3**

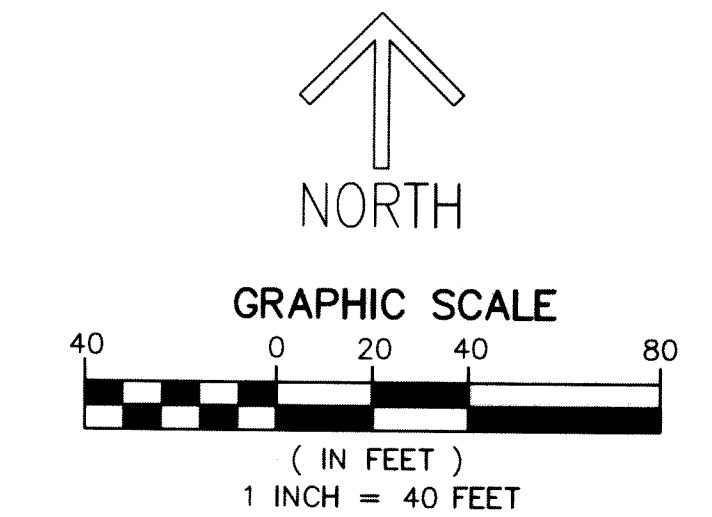

**NOTES**  
**COORDINATES, BEARINGS AND DISTANCES**  
 COORDINATES SHOWN ARE GRID  
 DATUM = NAD 83 (90 ADJUSTMENT)  
 ZONE = FLORIDA EAST  
 LINEAR UNIT = US SURVEY FEET  
 COORDINATE SYSTEM 1983 STATE PLANE  
 TRANSVERSE MERCATOR PROJECTION  
 ALL DISTANCES ARE GROUND  
 SCALE FACTOR = 1.0000236  
 GROUND DISTANCE X SCALE FACTOR = GRID DISTANCE  
 BEARINGS AS SHOWN HEREON ARE GRID DATUM,  
 NAD 83 (90 ADJUSTMENT), FLORIDA EAST ZONE.

**LEGEND/ABBREVIATIONS**  
 CL - CENTERLINE  
 Δ - DELTA (CENTRAL ANGLE)  
 (C) - CALCULATED  
 CB - CHORD BEARING  
 CD - CHORD DISTANCE  
 DE - DRAINAGE EASEMENT  
 E - EASTING (WHEN USED WITH COORDINATES)  
 L - ARC LENGTH  
 LB - LICENSED BUSINESS  
 L.W.D. - LAKE WORTH DRAINAGE DISTRICT  
 N - NORTHING (WHEN USED WITH COORDINATES)  
 NAD - NORTH AMERICAN DATUM  
 MOHE - MAINTENANCE AND OVERHANG EASEMENT  
 MXPD - MIXED USE PLANNED DEVELOPMENT  
 O.R.B. - OFFICIAL RECORD BOOK  
 PBCUE - PALM BEACH COUNTY UTILITY EASEMENT  
 PC - POINT OF CURVATURE  
 PI - POINT OF INTERSECTION  
 PNT - POINT OF NON TANGENCY  
 PT - POINT OF TANGENCY  
 PRAS - PRIVATE RESIDENTIAL ACCESS STREET  
 PUD - PLANNED UNIT DEVELOPMENT  
 R - RADIUS  
 UE - UTILITY EASEMENT  
 PRM - DENOTES SET PERMANENT REFERENCE MONUMENT  
 4" x 4" x 24" CONCRETE MONUMENT WITH  
 ALUMINUM DISK STAMPED "C&W PRM LB3591"  
 PCP - DENOTES SET PERMANENT CONTROL POINT  
 NAIL AND METAL DISK STAMPED "PCP LB3591"  
 (P) - FIELDS AT GULFSTREAM POLO PUD -  
 PLAT ONE, AS RECORDED IN PLAT  
 BOOK 123, PAGES 80 THROUGH 95

